

TECHNISCHES DATENBLATT

LED STRASSENLAMPE 2090S

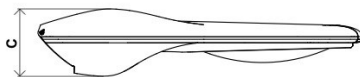

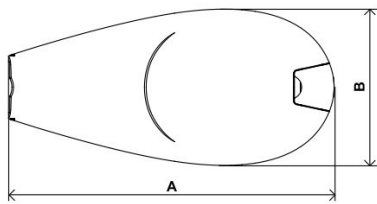
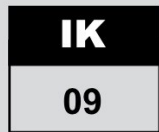
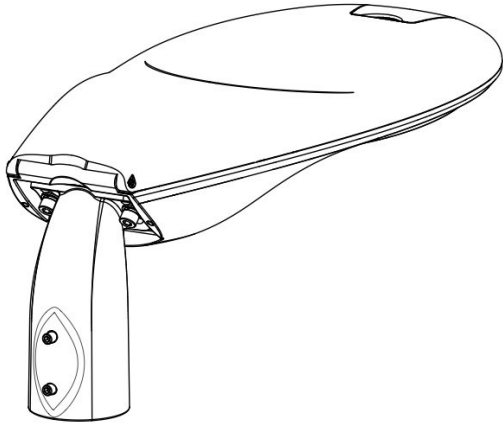

	A	B	C	C _r S	kg
Mini	540mm	260mm	112mm	0.11m ²	4.8

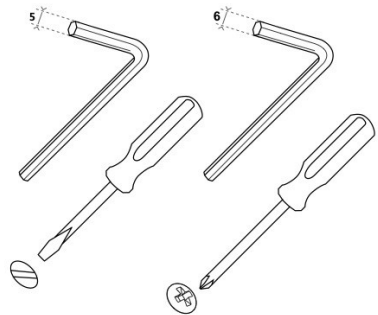

A

Ø 48 - 60mm

Ø 76mm

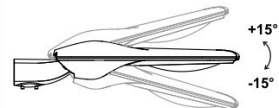
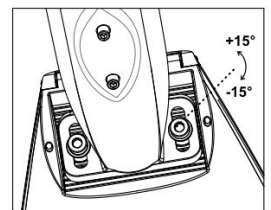
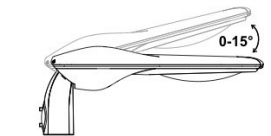
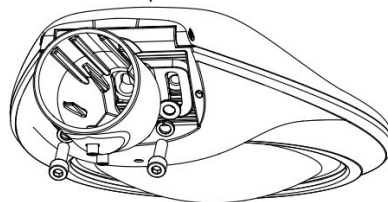
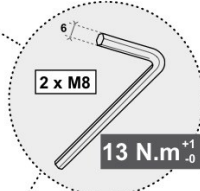
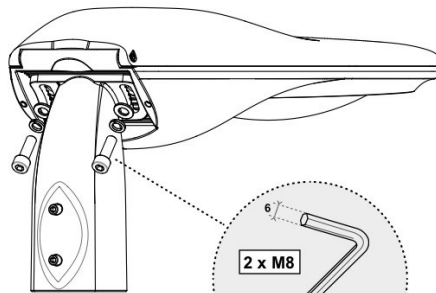
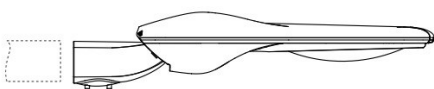
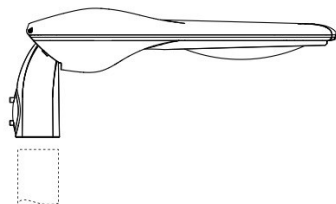
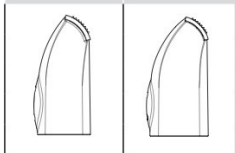

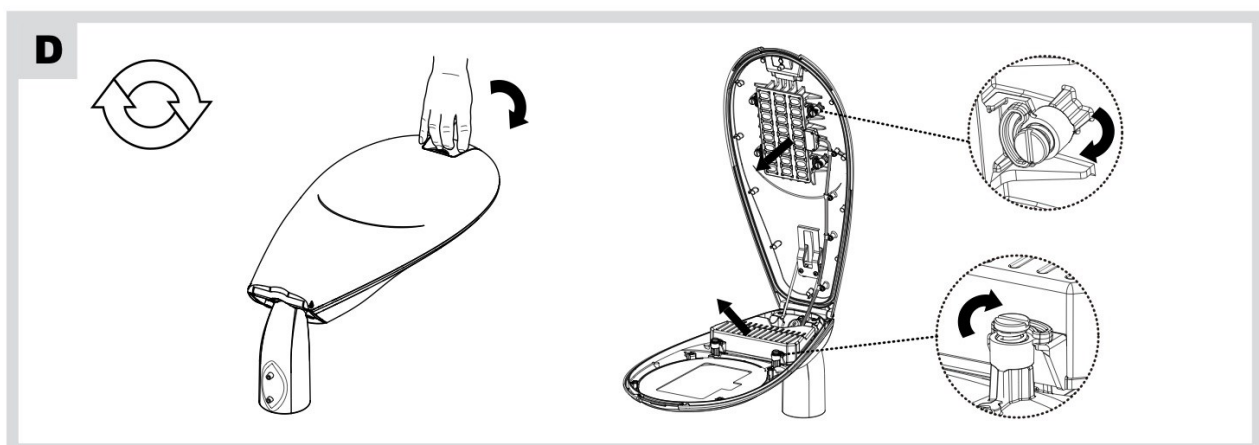
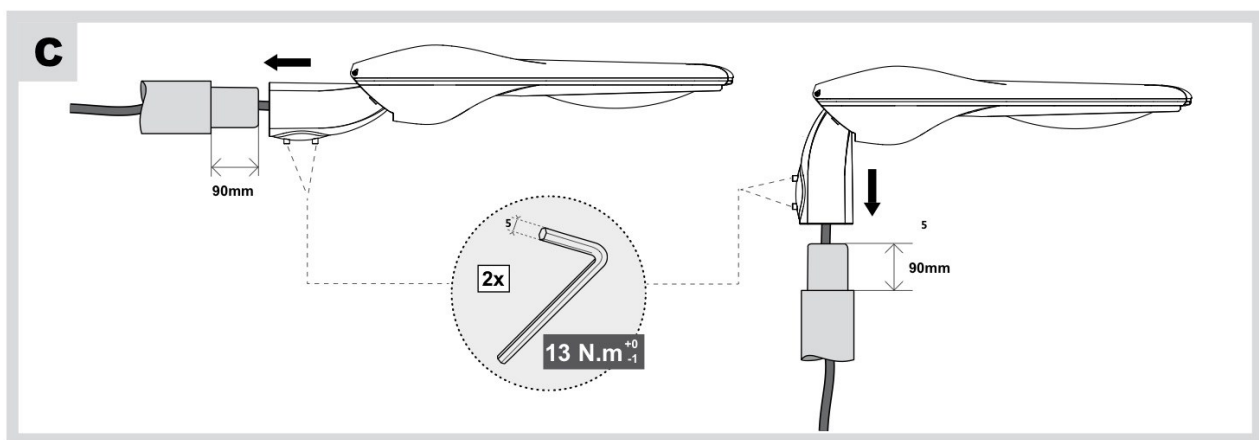
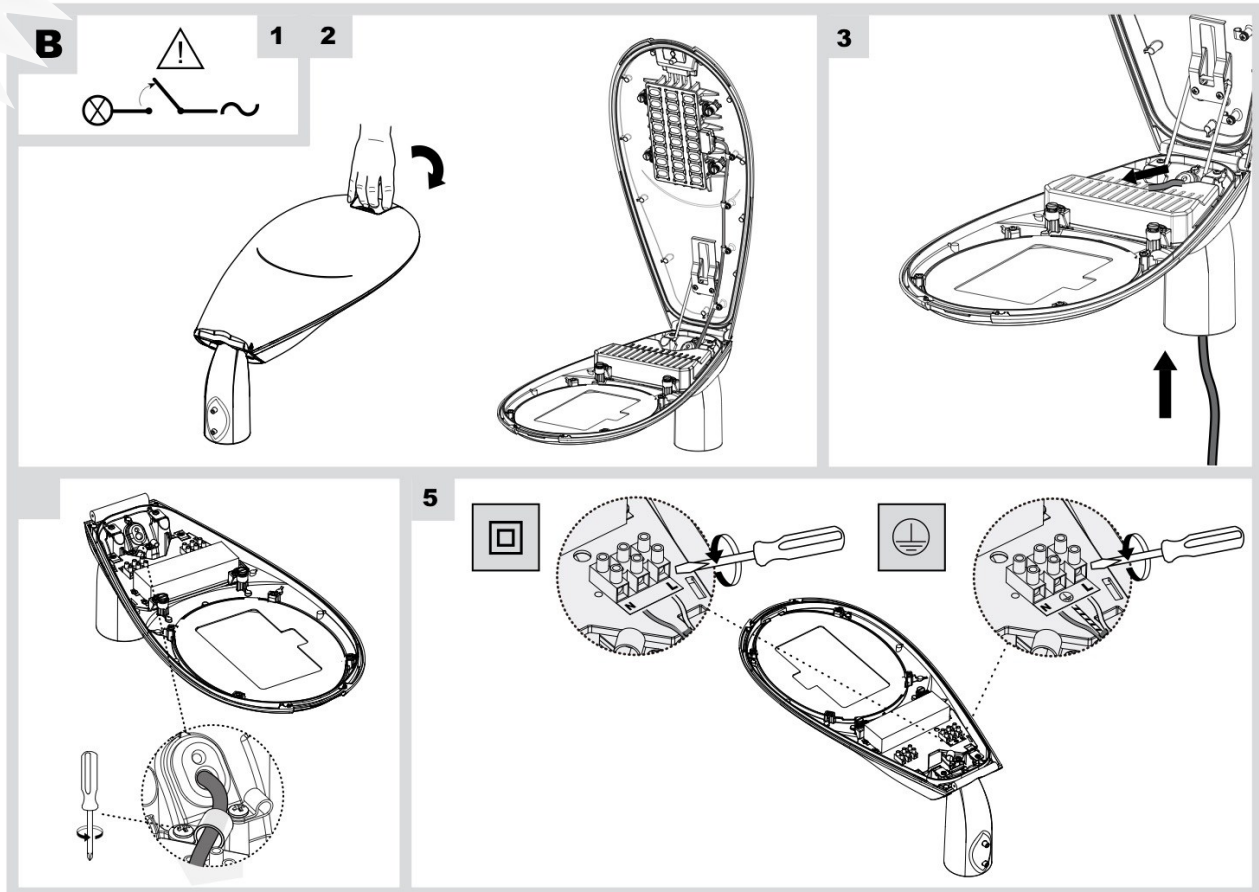

TECHNISCHE DETAILS

LED STRASSENLAMPE 2090S

Leistung W ±5% Toleranz	Lumen ±5% Toleranz	Eingangsspannung AC 50/60Hz	Anzahl LED Chips	Netzteil	LED Chips	Gewicht kg	Artikel- Nr.:
15 Watt	1800	120–277 V	18	Philips	Cree XP-G2	4,8	6038
20 Watt	2450	120–277 V	18	Philips	Cree XP-G2	4,8	
25 Watt	2980	120–277 V	18	Philips	Cree XP-G2	4,8	
30 Watt	3540	120–277 V	24	Philips	Cree XP-G2	4,8	6036
40 Watt	4550	120–277 V	24	Philips	Cree XP-G2	4,8	

Technische Daten:

LED Effizienz:	max. 150 lm/W
Lichtstrom Leuchte:	≥ 110 lm/W
Leistungsaufnahme:	zw. 15–40 W
LED:	4000 Kelvin CRI ≥ 70 R _a
LED Netzteil:	Philips Xitanium stufenlos programmierbar 1–10V + DALI Eingang Konstantlichtstromregelung opt. dimmbar über 2. Phase
Überspannungsschutz:	4 kV 2,5 kA integriert, opt. 10 kV 5kA mittels SDU
Lebensdauer LED:	60.000h L85B10 80.000h L80B10
Lebensdauer Treiber:	100.000h bei max. 70° Betriebstemperatur

Lichtaustritt:	direkt strahlend asymmetrisch, extrem breit
Gehäuse:	Aluminium Druckguss Abdeckung Chipboard aus Glas pulverbeschichtet, RAL Farbe wählbar
Schutzklasse:	IP66 IK09 SK I oder SK II (schutzisoliert)
Abmessungen:	Länge: 540mm Breite: 260 mm Höhe: 112 mm
Gewicht:	4,80 kg
Montage:	Mastansatz- oder Mastaufsatzmontage Zopfmasse: 42/60/76 mm neigbar 0°, 5°, 10°, 15°

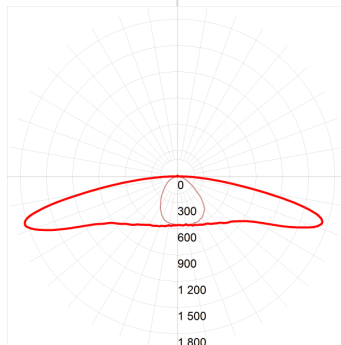



SOLEDIO
LICHTSYSTEME GMBH

Niels-Bohr-Str. 16

D-97941 Tauberbischofsheim

Tel.: +49 (0) 9341- 849 76 17

Fax: +49 (0) 9341- 849 76 19

E-Mail: info@soledio.de

Dieses Datenblatt wurde übergeben von: